

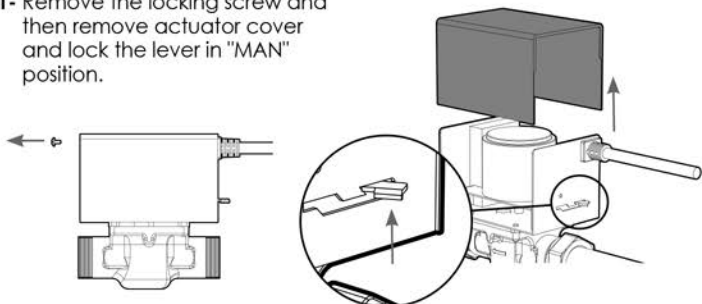

REPLACING ACTUATOR

REMOVAL

- 1- Remove the locking screw and then remove actuator cover and lock the lever in "MAN" position.



- 2- Loosen the 2 securing screws.

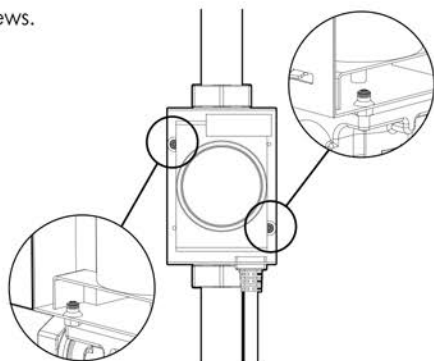

- 3- Lift actuator from valve body.



RE-FITTING

- 4- Ensure valve stem is in parallel position as indicated.

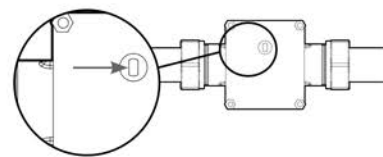

- 5- Push actuator onto valve and tighten 2 securing screws as indicated above.

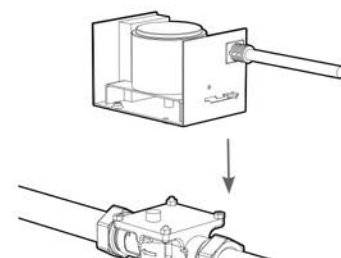

- 6- Replace the cover and screw. Release lever and allow to travel back to "AUTO".

