

# 06

# with flow rate adjuster ZEVR

## APPLICATION

Gas Solenoid Valves are used for safety and control of gas for shut-off in gas feed pipes  
 Suitable for various gases, including Natural gas, Propane and LPG  
 ¼" Inlet and outlet plugs suitable for CPI switch, pressure gauge, connection to proving and interlock systems

## OPERATION AND INSTALLATION

Two-way, normally-closed - energise to open  
 Rapid opening  
 Adjustable flow rate regulator on top of the coil  
 Mounting direct on pipeline more or less 90 degrees (max) from the vertical axis

## TECHNICAL SPECIFICATION

Opening time <1 second  
 Closing time <1 second  
 Max number of operations : 20 per minute  
 ¼" Inlet and outlet plugs  
 Incorporated AISI 303 steel mesh filter  
 Cable entry gland PG11 Live, Neutral, Earth  
 Protection to IP54  
 NBR based seal with a strong resistance to hydrocarbons (UNI 4916-74)  
 Bodies and flanges in diecast aluminium  
 AISI 302 steel pressure spring  
 Chromate Fe 37 steel armature  
 Ambient temperature -15°C to 60°C  
 Coil temperature about 70°C

## STANDARDS AND APPROVALS

Class "A" BS EN161:2013 Approved  
 British Gas & European Standards  
 90/396/EEC - 73/23/EEC - 89/336/EEC  
 Certificate CE EC-0063CP1844

## ELECTRICAL SPECIFICATION

Supply voltage 230V (-15%+10%) 50-60Hz  
 Coils to Class F, 360° rotation, suitable for permanent excitation

## NORMALLY CLOSED - 230VAC

TYPE	SIZE	CONNECTION	MAX PRESS.	POWER VA
ZEVR10	¼"	BSP	360 mbar	15
ZEVR15	½"	BSP	350 mbar	15
ZEVR20	¾"	BSP	360 mbar	22
ZEVR25	1"	BSP	360 mbar	22
ZEVR32	1¼"	BSP	360 mbar	42
ZEVR40	1½"	BSP	360 mbar	42
ZEVR50	2"	BSP	360 mbar	50
ZEVR65	2½"	BSP	360 mbar	72
ZEVR80	3"	BSP	360 mbar	72

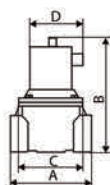

Type	A	B	C	D
ZEVR10	72	121	52	85
ZEVR15	72	121	52	85
ZEVR20	86	168	70	96
ZEVR25	100	168	75	96
ZEVR32	150	233	110	118
ZEVR40	150	233	110	118
ZEVR50	170	260	135	123
ZEVR65	220	330	170	145
ZEVR80	220	330	170	145



ZEVR25



ZEVR50

