

## Product Introduction

The FSL-65(IP65) Water Flow Switch can be installed on the water pipe and in the liquid that is not corrosive to brass. It can be typically used to the location that have linkage function to liquid break protection.

## Specification

Working Press.	1.0MPa	Contact Life	1000K Cyc
PN	1.75MPa	Bellow Life	50K Cyc
Resistance	> 100W.DC500VM	Temperature	MAX. 100°C
Dielectric Withstand	AC1500V/1min	Thread	G3/4" & 1"

## Contact Capacity

Type	Voltage Rating	Load
AC	AC125V AC250V	5A 2.5A
DC	DC115V DC250V	0.3A 0.15A

## Flow Control Range

Type		Flow Range ( LPM )			
( Pipe Inch )	Slice	MIN.		MAX.	
		ON	OFF	ON	OFF
1	1	15	8	45	41
1-1/4	1	26	13	75	68
1-1/2	1	29	20	105	94
2	2	34	17	120	105
2-1/2	2	60	34	210	188
3	2	68	30	288	275
4	3	128	64	412	360
5	3	225	113	750	652
6	3	345	172	1125	975

Note: This table is experiment data. It needs to be considered 10% surplus. (LPM: kilolitre/minute)

## Instruction

\* LKB-01 series switch can be used in the liquid medium over 0 degC. It can also be used in high salt or chlorine gas liquid which is not inflammable.

\* The water switch can be installed outdoor, but it must be prevented from rain (except IP65 model), and it can be installed on the vertical or horizontal pipe.

\* The liquid switch can not be hit by water, you must use restrictor if there is a quick shut valve under the switch.



## Dimension

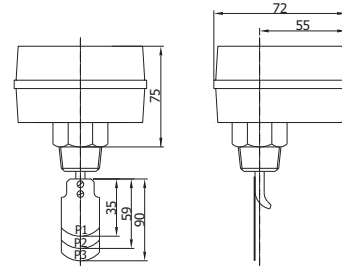

## Internal Structure

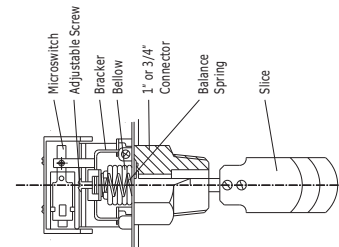

## Installation

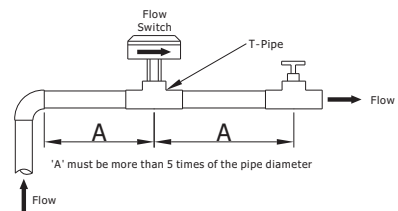

## Wiring

